

# R-TFIX-8M Facade fixing with metal nail

Versatile hammer-in facade fixing with steel nail recommended for ETICS.



## Approvals and Reports

- ETA 17/0592



## Product information

### Features and benefits

- Quick and easy installation in all substrates (categories A,B,C,D,E)
- Unique sleeve compression zone for precision installations.
- Reduced point thermal transmittance to 0.001W/K thanks to high steel nail overmold, which decreases facade heat losses
- Highest loads with anchoring zone reduced in length to 25 mm
- Excellent plate stiffness (value 1.0 kN/mm) ensures smooth elevation surface and stable insulation system.
- Increased head diameter enabling centric hammer driving for improved installation comfort
- Pre-assembled components of the fixing allow you to save time

### Applications

- External Thermal Insulation Composite Systems (ETICS)
- Polystyrene (EPS) boards
- Mineral wool (MW) boards
- Polyurethane (PU) boards
- Cork boards
- Light wood wool building boards

### Base materials

#### Approved for use in:

- Concrete C12/15-C50/60 (Use category A)
- External wall panel of concrete C16/20 – C50/60 (Use category A)
- Solid Brick (Use category B)
- Solid Sand-lime Brick (Use category B)
- Hollow Sand-lime Brick (Use category C)
- Vertically-perforated clay block (Use category C)
- Reinforced components of lightweight aggregate concrete (Use category D)
- Aerated Concrete Block (Use category D)
- Hollow Lightweight Concrete

## Installation guide

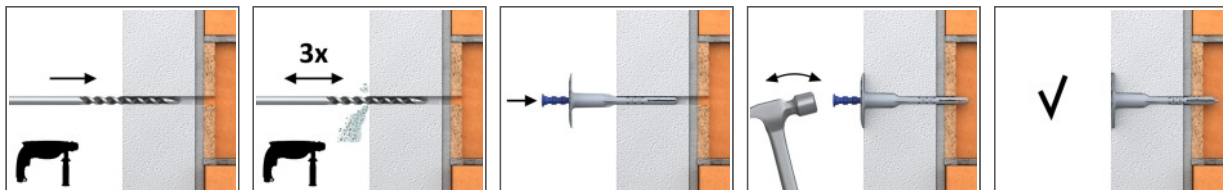

1. Drill a hole of required diameter and depth
2. Drilling depth of min 35mm in A,B,C,D materials and 75mm in Aerated Concrete Block.
3. Clean drilled hole 3 times.
4. Bottom side of the plate must be flush with the ETICS.
5. Embedment depth of min 25mm in A,B,C,D materials and 65mm in Aerated Concrete Block.
6. Hammer the nail into the plastic sleeve until fixing is secure and flush with insulation material.
7. In soft insulation panels the fixing should be combined with insulation retaining plates KWL-90, KWL-110, KWL-140.

**Product information**

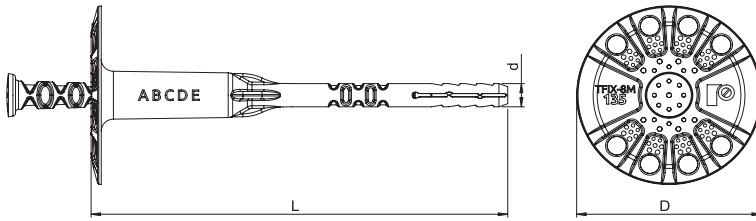

Size	Product Code	Fixing			Fixture	
		Diameter	Plate diameter	Length	Recommended thickness	
		d	D	L	t <sub>fix</sub> A, B, C, D	t <sub>fix</sub> E
[mm]						
Ø8	R-TFIX-8M-135	8	60	135	100	60
	R-TFIX-8M-155	8	60	155	120	80
	R-TFIX-8M-175	8	60	175	140	100
	R-TFIX-8M-195	8	60	195	160	120
	R-TFIX-8M-215	8	60	215	180	140
	R-TFIX-8M-235	8	60	235	200	160
	R-TFIX-8M-255	8	60	255	220	180
	R-TFIX-8M-275	8	60	275	240	200
	R-TFIX-8M-295	8	60	295	260	220

**Installation data**

Substrate			A, B, C, D	E	External wall panel
Fixing diameter	d	[mm]	8	8	8
Hole diameter in substrate	d <sub>0</sub>	[mm]	8	8	8
Min. hole depth in substrate	h <sub>0</sub>	[mm]	35	75	35
Min. installation depth	h <sub>nom</sub>	[mm]	25	65	25
Min. substrate thickness	h <sub>min</sub>	[mm]	100	100	40
Min. spacing	s <sub>min</sub>	[mm]	100	100	100
Min. edge distance	c <sub>min</sub>	[mm]	100	100	100

**Basic performance data**

Performance data for single anchor without influence of edge distance and spacing

Substrate		Concrete C12/15	Concrete min. C16/20	External wall panel of concrete	Solid clay brick min 20MPa (eg M220/Z-0)	Sand-lime brick min. 30MPa	Sand-lime hollow block min. 20MPa	Hollow brick min. 15MPa	Prefabricated reinforced components of lightweight aggregate concrete 4MPa	Aerated concrete AAC5
		[mm]	[kN]	[kN]	[kN]	[kN]	[kN]	[kN]	[kN]	[kN]
Effective embedment depth h <sub>ef</sub>	[mm]	25	25	25	25	25	25	25	25	25
<b>MEAN ULTIMATE LOAD N<sub>Ru,m</sub></b>										
R-TFIX-8M	[kN]	1.41	1.54	1.41	1.54	1.54	1.41	0.64	0.64	1.28
<b>CHARACTERISTIC LOAD N<sub>Rk</sub></b>										
R-TFIX-8M	[kN]	1.10	1.20	1.10	1.20	1.20	1.10	0.50	0.50	1.00
<b>DESIGN LOAD N<sub>Rd</sub></b>										
R-TFIX-8M	[kN]	0.55	0.60	0.55	0.60	0.60	0.55	0.25	0.25	0.50
<b>RECOMMENDED LOAD N<sub>rec</sub></b>										
R-TFIX-8M	[kN]	0.39	0.43	0.39	0.43	0.43	0.39	0.18	0.18	0.36

## Basic performance data

Fixing type		R-TFIX-8M
Plate resistance	[kN]	1.53
Plate stiffness	[kN/mm]	1
Point thermal transmittance	[W/K]	0.001

## Product commercial data

Size	Product Code	Fixing			Quantity [pcs]			Weight [kg]			Bar Codes
		Diameter [mm]	Plate diameter [mm]	Length [mm]	Box	Outer	Pallet	Box	Outer	Pallet	
Ø8	R-TFIX-8M-135 <sup>1)</sup>	8	60	135	200	200	8000	3.1	3.1	152.9	5906675269436
	R-TFIX-8M-155 <sup>1)</sup>	8	60	155	200	200	6400	4.0	4.0	157.0	5906675269443
	R-TFIX-8M-175 <sup>1)</sup>	8	60	175	200	200	6400	4.1	4.1	160.0	5906675269450
	R-TFIX-8M-195 <sup>1)</sup>	8	60	195	200	200	6400	5.4	5.4	201.2	5906675269467
	R-TFIX-8M-215 <sup>1)</sup>	8	60	215	100	100	4000	2.7	2.7	138.8	5906675269474
	R-TFIX-8M-235 <sup>1)</sup>	8	60	235	100	100	4000	2.8	2.8	140.7	5906675269481
	R-TFIX-8M-255 <sup>1)</sup>	8	60	255	100	100	4000	2.9	2.9	144.6	5906675269498
	R-TFIX-8M-275 <sup>1)</sup>	8	60	275	100	100	4000	2.9	2.9	147.4	5906675269504
	R-TFIX-8M-295 <sup>1)</sup>	8	60	295	100	100	4000	3.0	3.0	150.2	5906675269511
Ø63	R-KFS-63				1	16	384	0.07	1.10	56.5	5906675390307

1) ETA 17/0592